



GOOD EARTH
TRADE
TOWER

TRADE
TOWER

THE ULTIMATE BUSINESS ADDRESS



GOOD EARTH
TRADE
TOWER



About Us

Established in 2005, Good Earth Infra is a privately held, full-service real estate development, investment, and management firm based out of Delhi NCR.

Since inception, we've delivered 3 million SF of office and retail and have catered to 1000+ customers.

Taking office development to the next level, we now bring to you Good Earth Trade Tower, an asset offering 350,000 SF of Grade A workplaces.

Highlights



Total SF: 350,000

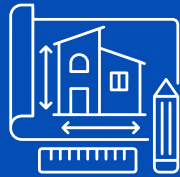

Structure: 3B+G+16



Delivered on:
March, 2024



Typical Floor Plate:
25,000 SF



Nearest
Metro Station: 4 KM



Ownership Structure:
Developer/Single
owned

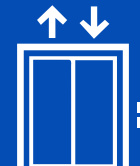

No. of Elevators: 7

Amenities



F&B Outlets



Shuttle Services
to DMRC Metro



IGBC Gold
Certification



Co-Working
Operator



Lobby
Coffee Shop



Ambulance



Mini Convenience
Store



Quick
Response Team



Merv-15 Air
Filtration



ATM



24x7
Maintenance



Amphitheater



Location



1 km from Golf Course
Extension Road



Quick access to NH8 through
multiple underpasses on
Golf Course Road and Cyber City



4 km from the nearest
Rapid Metro Station



24 km from IGI Airport



Residential catchment of 10,000
apartment units within <500 mtr.
radius (EMAAR Digi Homes,
DLF Arbour, Time Residency)

Location Map



Pickup & Dropoff Area



Reception



Lift Lobby



Amphitheater

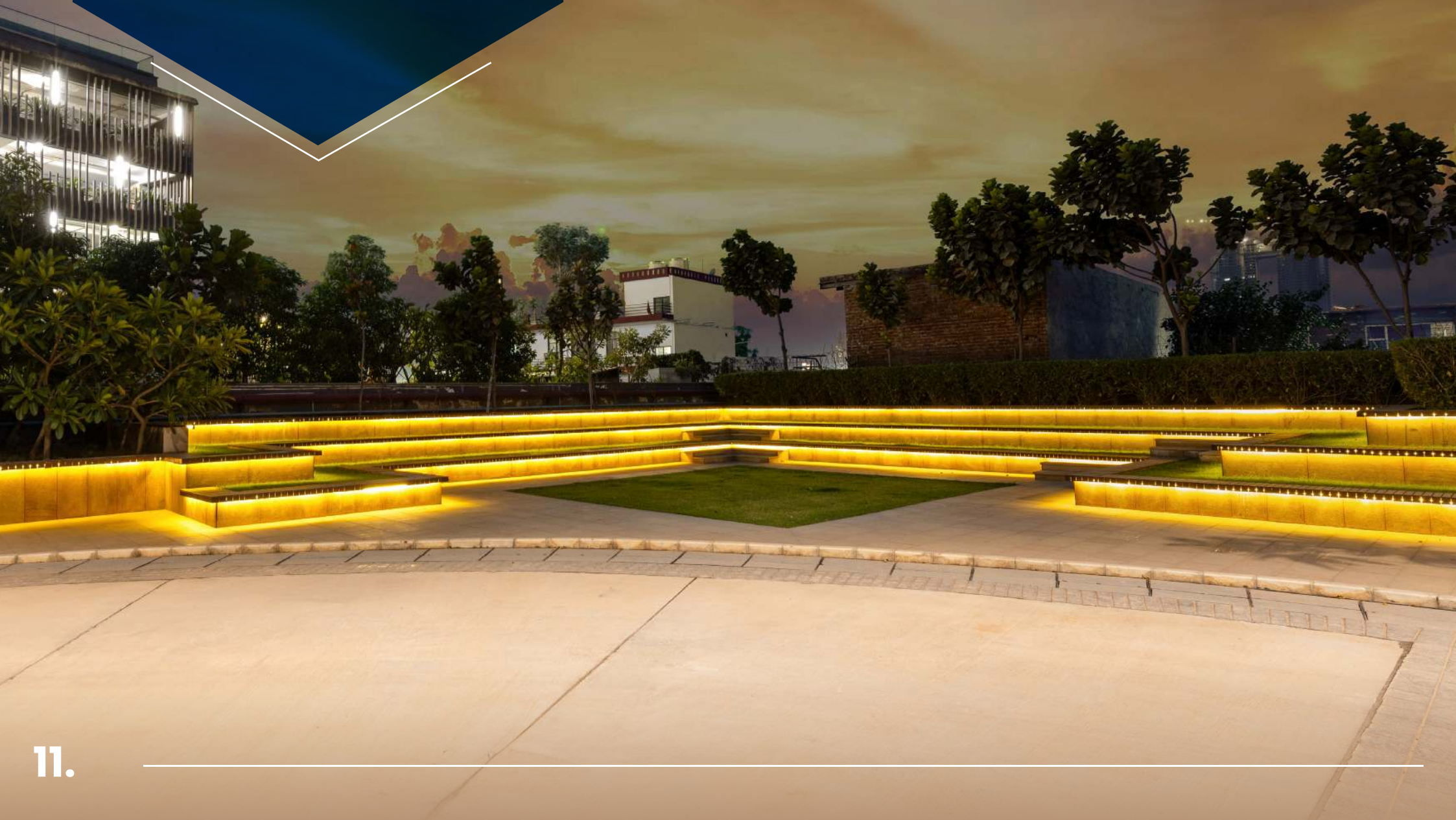

Floor No.	Super Area (Approx in SF)
1 st	17,000
2 nd	25,000
3 rd	25,000
4 th	25,000
5 th	25,000
6 th	25,000
7 th	25,000
8 th	25,000
9 th	25,000
10 th	25,000
11 th	25,000
12 th	25,000
14 th	19,500
15 th	16,000
16 th	9,500
Total	3,37,000



Area Chart

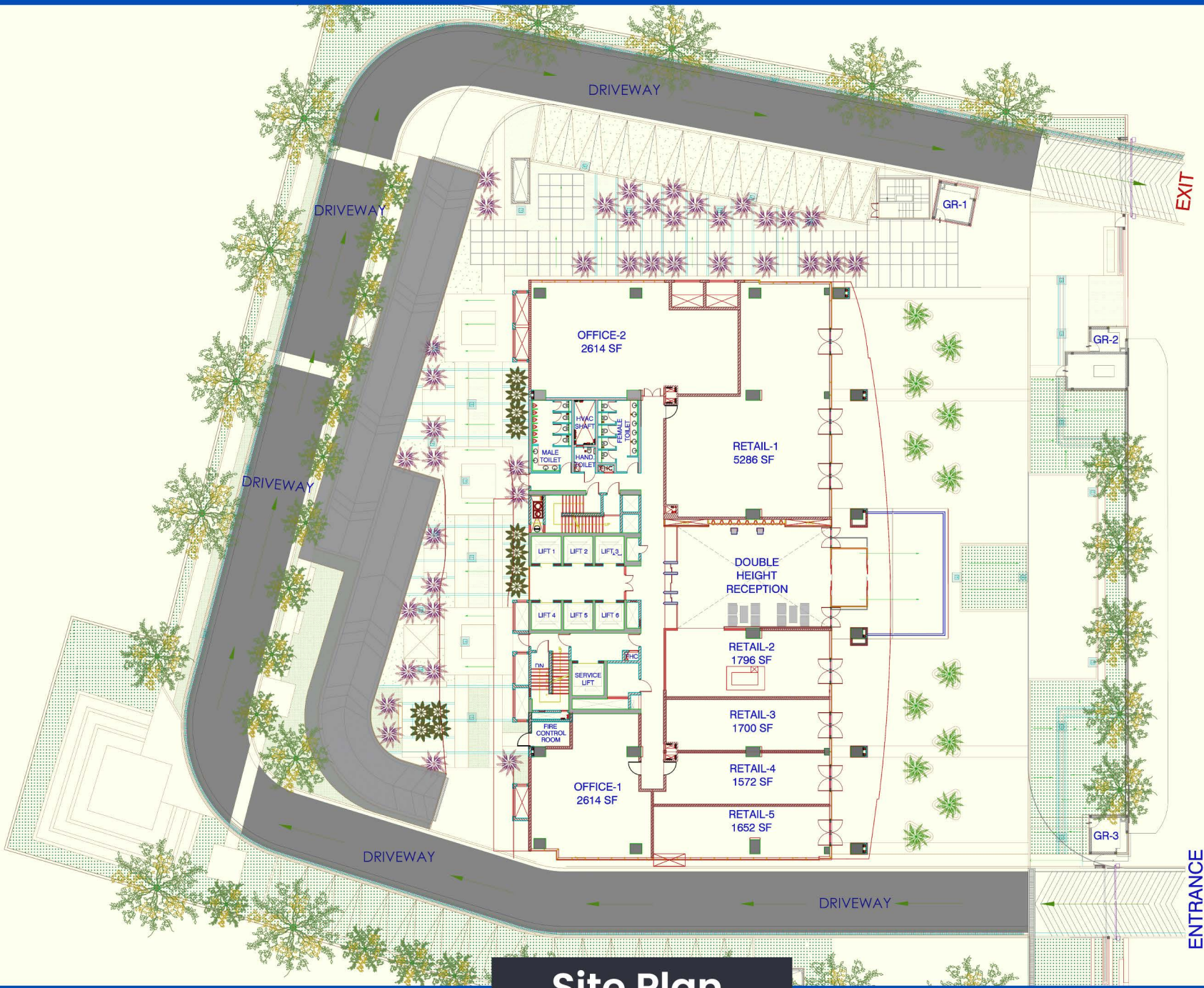

Site Plan

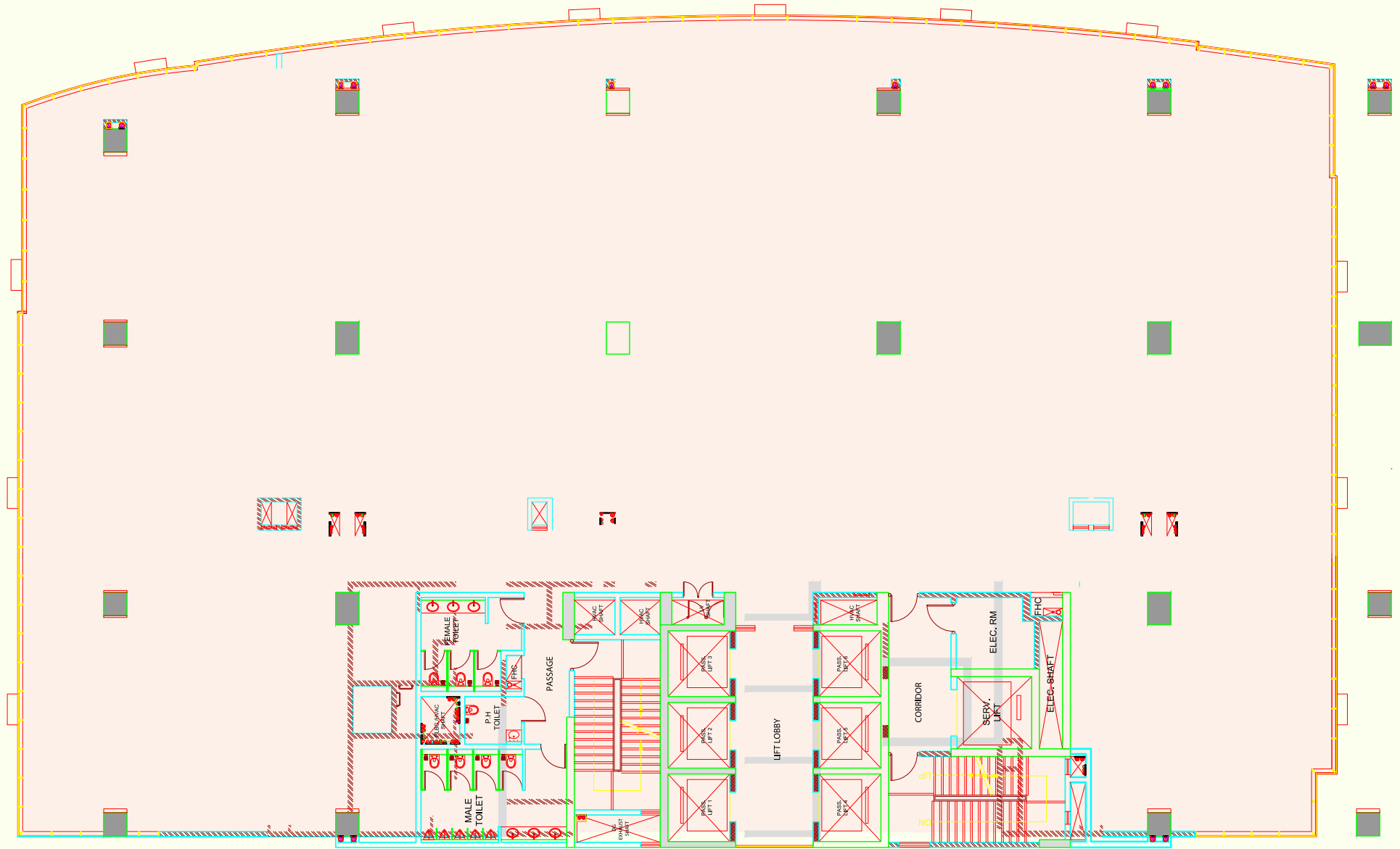

Typical Floor

Our Presence

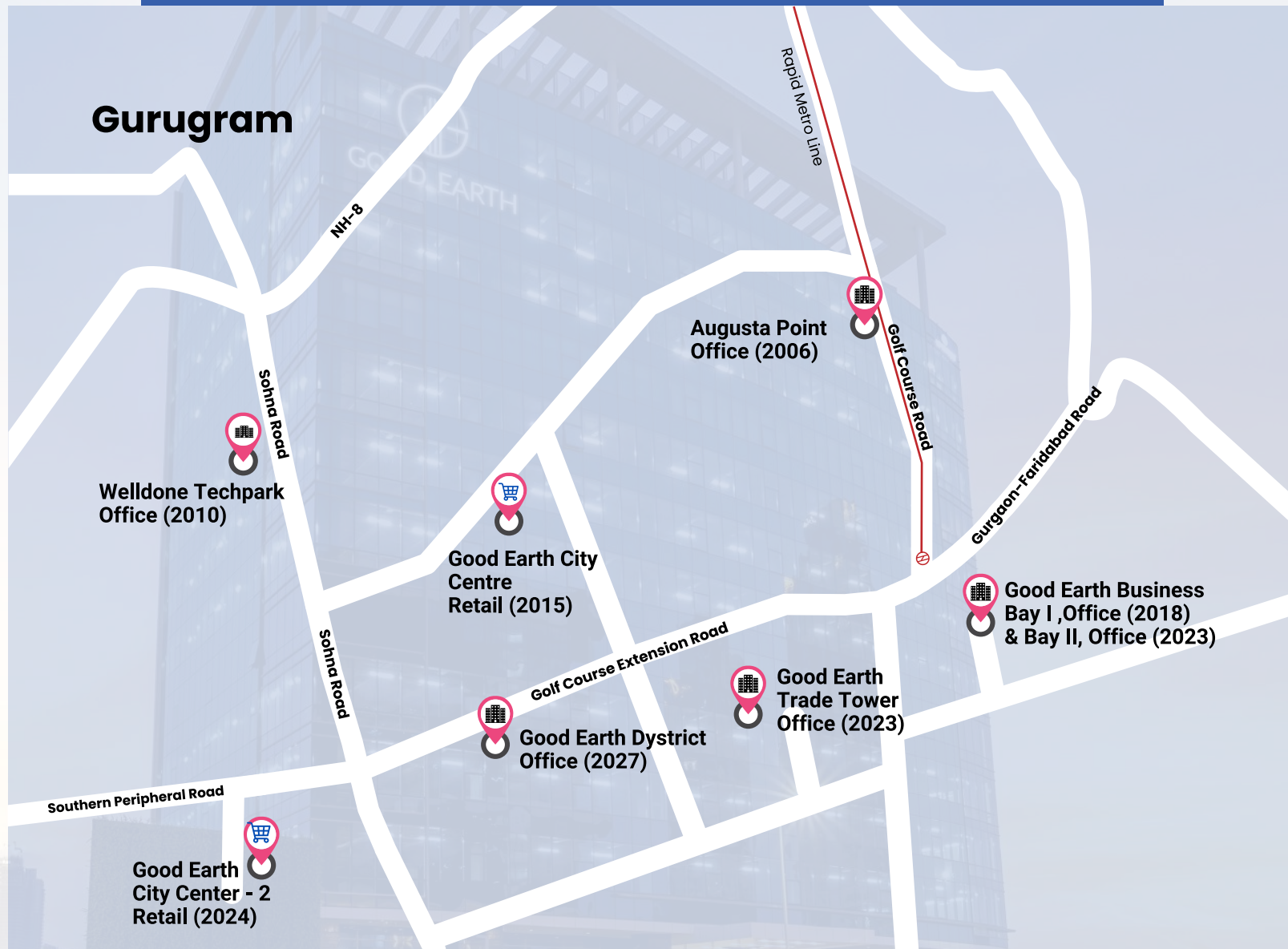

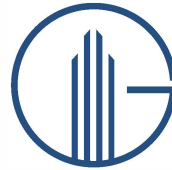

GOOD EARTH INFRA
Building Tomorrow, Today

CONTACT US

Harsh Shukla
VP - Leasing

☎ +918527650829

✉ harsh@galaxy-group.in

Ayush Kulshreshtha
DGM - Leasing & Sales

☎ +918800880062

✉ ayush@galaxy-group.in