

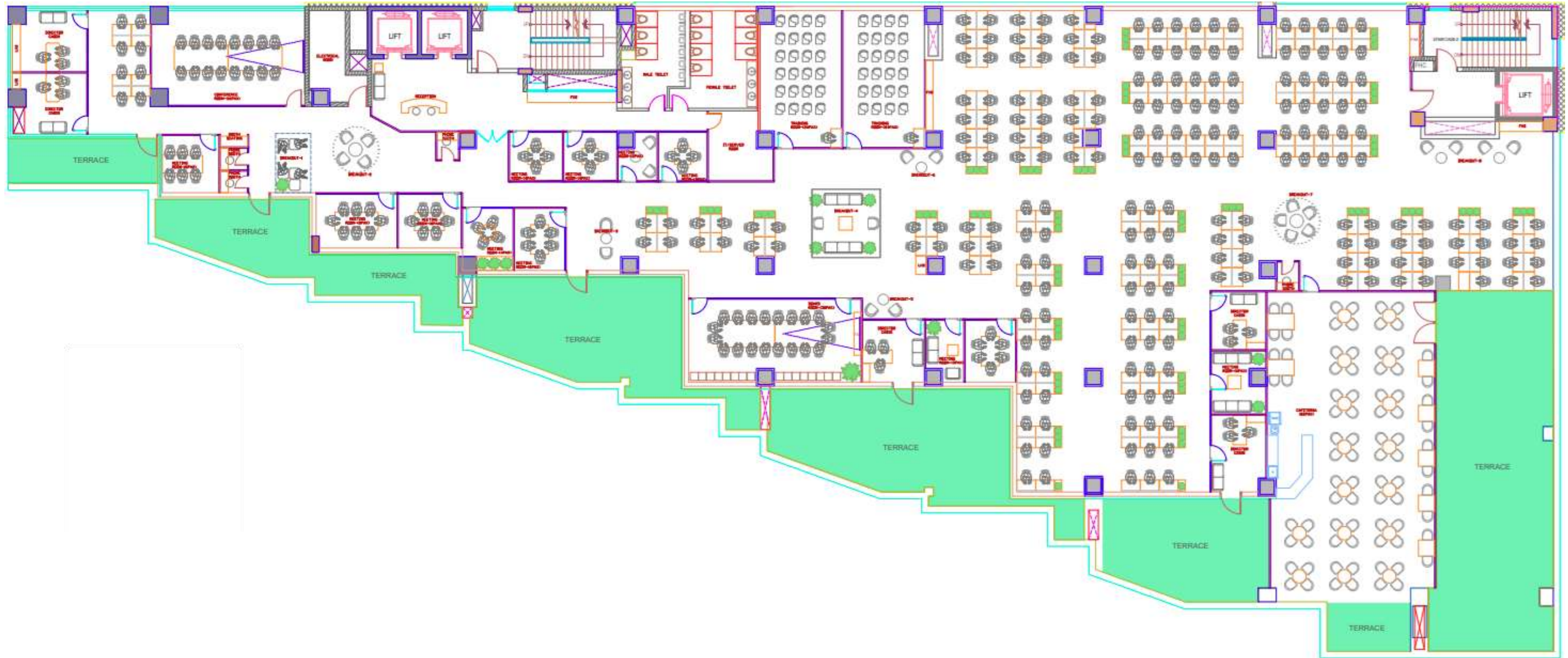

GOOD EARTH INFRA

Building Tomorrow, Today

# 9<sup>th</sup> Floor



| LEGENDS |                               |      |
|---------|-------------------------------|------|
| S.No    | Description                   | QTY. |
| 1.      | Workstations (3550x603)       | 230  |
| 2.      | Board Room (30 Pax)           | 1    |
| 3.      | Conference Room (36 Pax)      | 1    |
| 4.      | Cafeteria                     | 1    |
| 5.      | Meeting Rooms                 | 12   |
| 6.      | Server Room/UPS               | 1    |
| 7.      | Directors-Cabins              | 5    |
| 8.      | Phone Booth                   | 4    |
| 9.      | Training Room                 | 2    |
| 10.     | Breakout Area's               | 8    |
| 11.     | Reception Area & Utility Area | 1    |