



# **GOOD EARTH** BUSINESS BAY II

## **CONTEMPORARY SPACES**

FOR SUSTAINABLE GROWTH





## About Us

Established in 2005, Good Earth Infra is a privately held, full-service real estate development, investment, and management firm based out of Delhi NCR.

Since inception, we've delivered 3 million SF of office and retail space and have catered to 1000+ customers.

Taking office development to the next level, we now bring to you Good Earth Business Bay II, an asset offering 320,000 SF of Grade A workplaces.

# Highlights

---



Total SF: 330,000

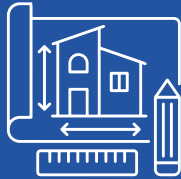

Structure: 3B+G+10



Delivered On:  
October, 2023



Typical Floor Plate:  
37,000 SF



Nearest  
Metro Station: 2.3 KM



Ownership Structure:  
Developer/Single  
Owned

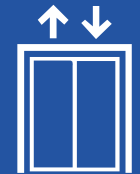

No. of Elevators: 7

# Amenities

---



South Indian  
Restaurant



Pan Asian Cafe



LEED PLATINUM  
Certification



Shuttle Services to  
DMRC Metro



Merv-15 Air  
Filtration



Medical Room  
With Ambulance



24x7 Operations



Lobby  
Coffee Shop



Mini Convenience  
Store



Quick  
Response Team



Valet Parking





## Location



At the Intersection of Golf Course Road and Golf Course Extension Road



Quick Access to NH8 through multiple underpasses on Golf Course Road and Cyber City



2.3 km from the nearest Rapid Metro Station



20km from IGI Airport



Residential Catchment of 10,000 apartment units within <500 mtr. radius (Hines, Ireo, Mahindra)

## Location Map

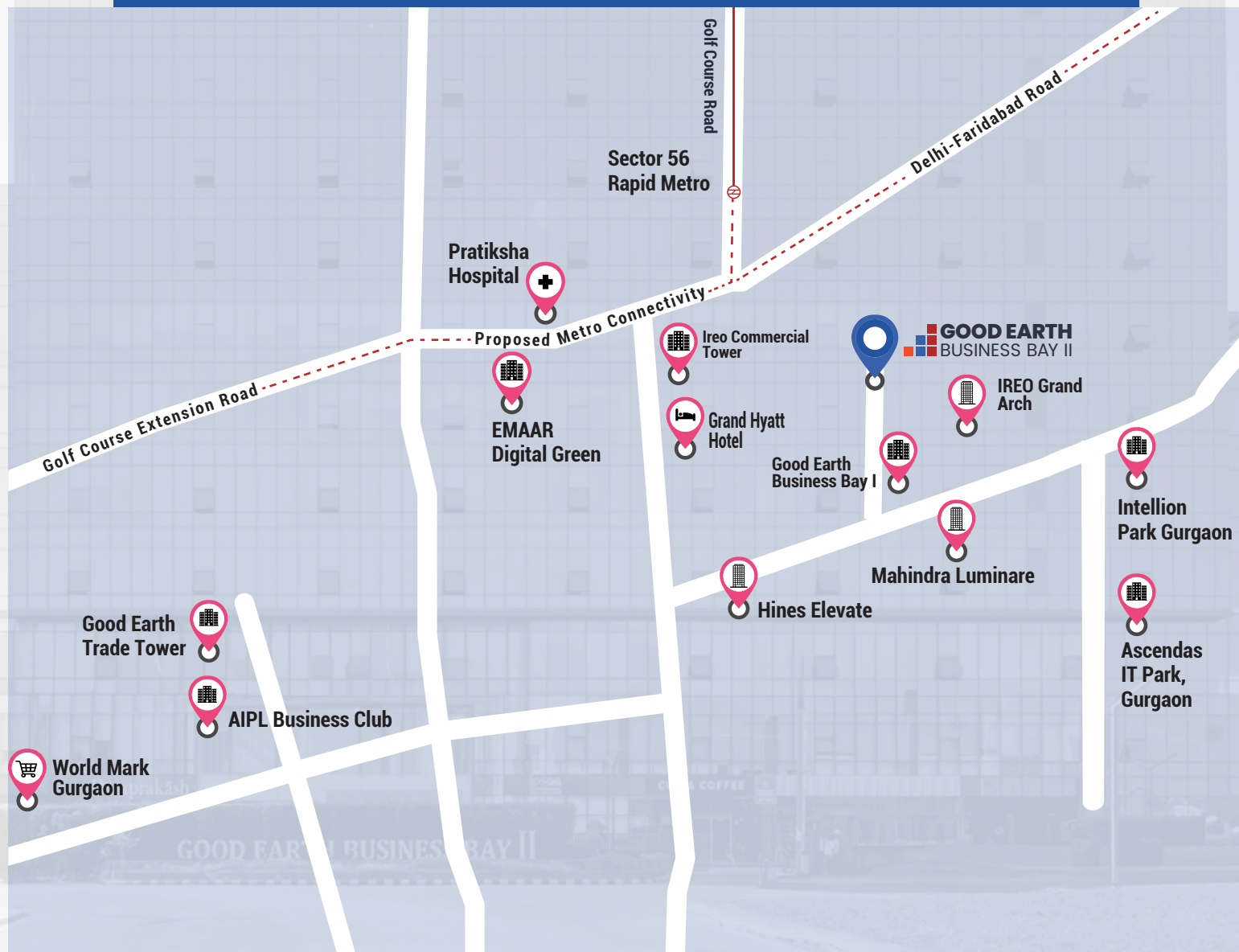





## Pickup & Dropoff Area



# Reception





## Lift Lobby





# F&B Costa Coffee





# F&B Dasaparakash





# F&B Hong's Kitchen





## Shuttle Service to Metro Station





# Quick Response Team







Floor No.	Super Area (Approx in SF)
1 <sup>st</sup>	35,000
2 <sup>nd</sup>	37,000
3 <sup>rd</sup>	37,000
4 <sup>th</sup>	37,000
5 <sup>th</sup>	34,000
6 <sup>th</sup>	30,000
7 <sup>th</sup>	30,000
8 <sup>th</sup>	26,000
9 <sup>th</sup>	24,000
10 <sup>th</sup>	20,000
Total	3,10,000

Area Chart







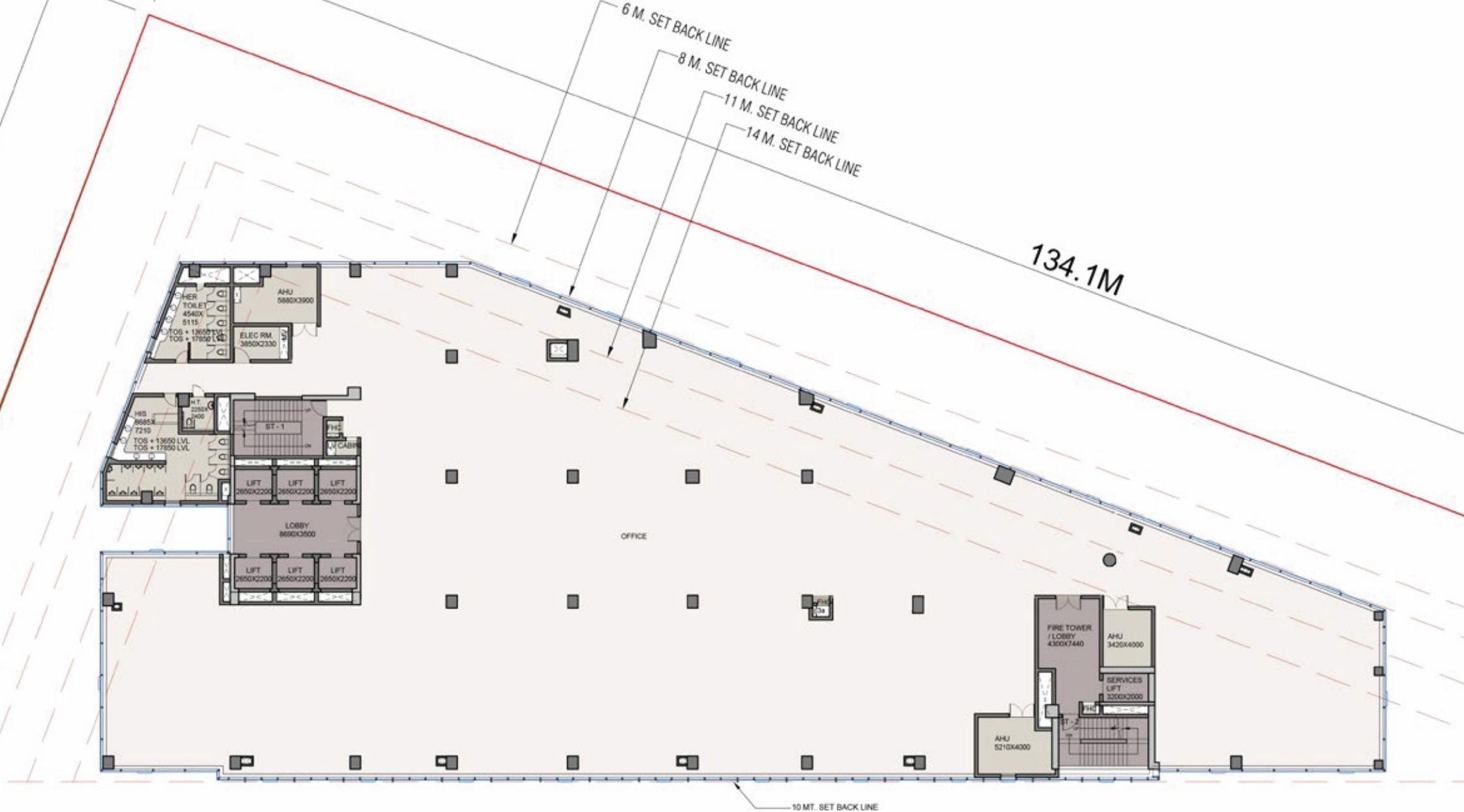

Typical Floor



## Our Presence

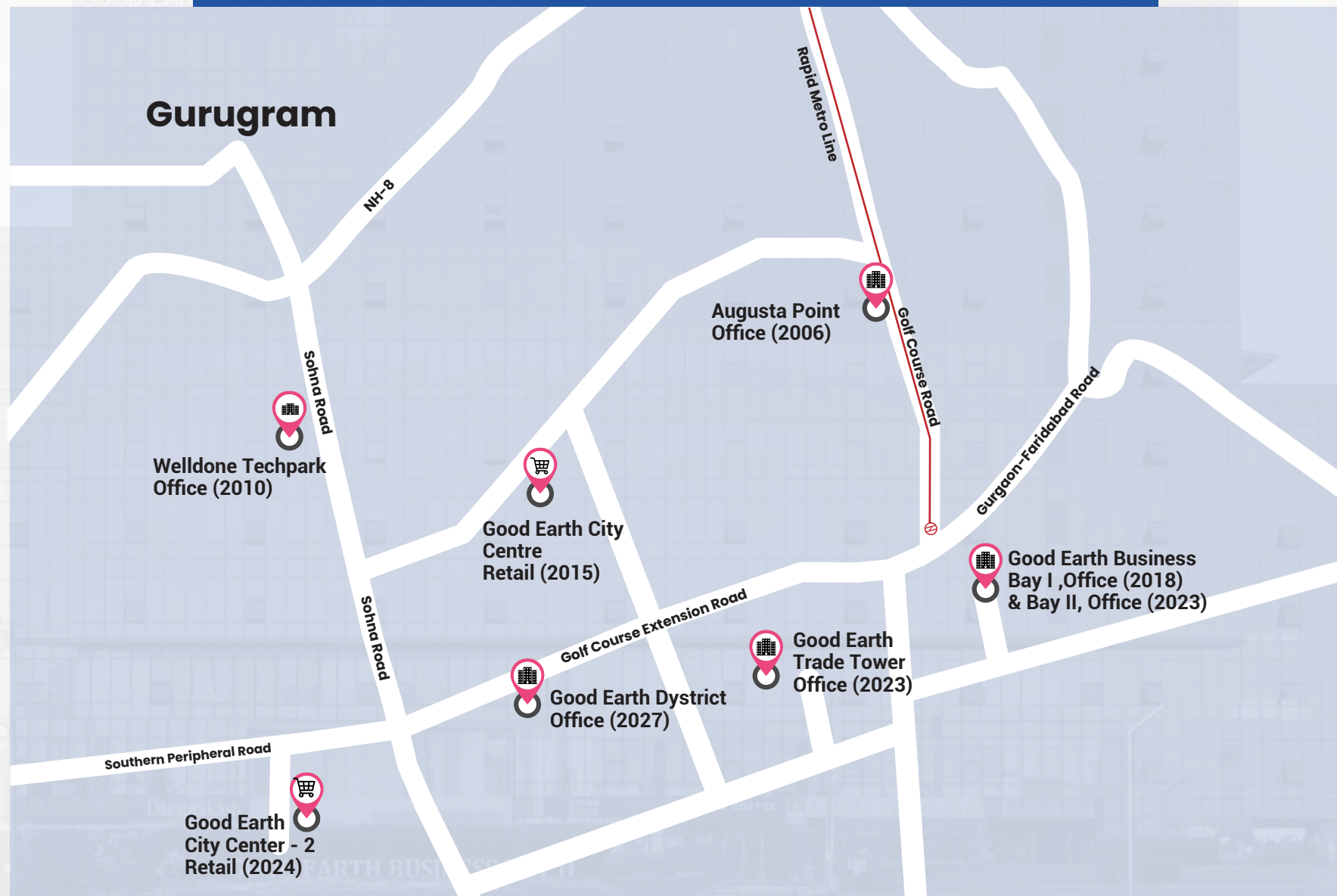



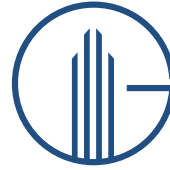

GOOD EARTH INFRA  
Building Tomorrow, Today

## CONTACT US

**Harsh Shukla**  
VP - Leasing

📞 +919711002611 | 8527650829

✉️ [harsh@goodearthinfra.in](mailto:harsh@goodearthinfra.in)

**Alisha Ali**  
Manager - Leasing

📞 +918800880062

✉️ [alisha@goodearthinfra.in](mailto:alisha@goodearthinfra.in)

# GOOD EARTH BUSINESS BAY II